

**WELL CONSTRUCTION REPORT**  
**WISCONSIN STATE BOARD OF HEALTH**  
**WELL CONSTRUCTION DIVISION**

✓ JAN 13 1944

Note: Section 31 of the Wisconsin Well Construction Code, having the force and effect of law, provides that within thirty days after completion of every well the driller shall submit a report covering all essential details of construction to the State Board of Health on a form provided by the Board.

Owner Seth Childs Driller Ernest S. Waters  
 Street or RFD \_\_\_\_\_ Post Office Boscobel Wis  
 Post Office Boscobel Wis. Date Jan 11 1944 Permit No. 137.

**LOCATION OF PREMISES**

Crawford County Scott. Town  
NE 1/4 of NW 1/4 - Sec 3, Twp. 9, Range 3W.  
 Describe further by subdivision, plat, district, lake, lot.  
Town road.  
 block, nearest principal highway, etc., whichever apply.

The square below represents a section of land divided into 40 acre tracts. Mark the position of the premises in the section.

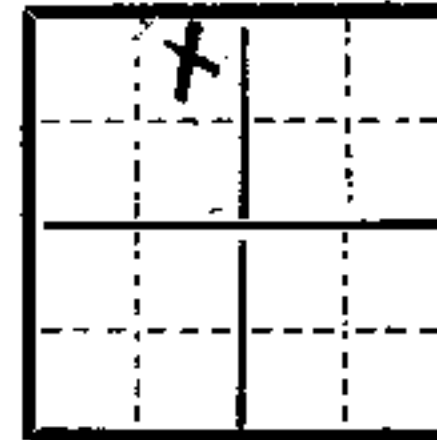

Sec. No. 3  
 Twp. No. 9  
 Range 3 { W

**DIAGRAM OF PREMISES**

See Well Construction Report bulletin. In making the diagram in the space below consider 10 ft. as the distance between lines. Be sure to indicate NORTH.

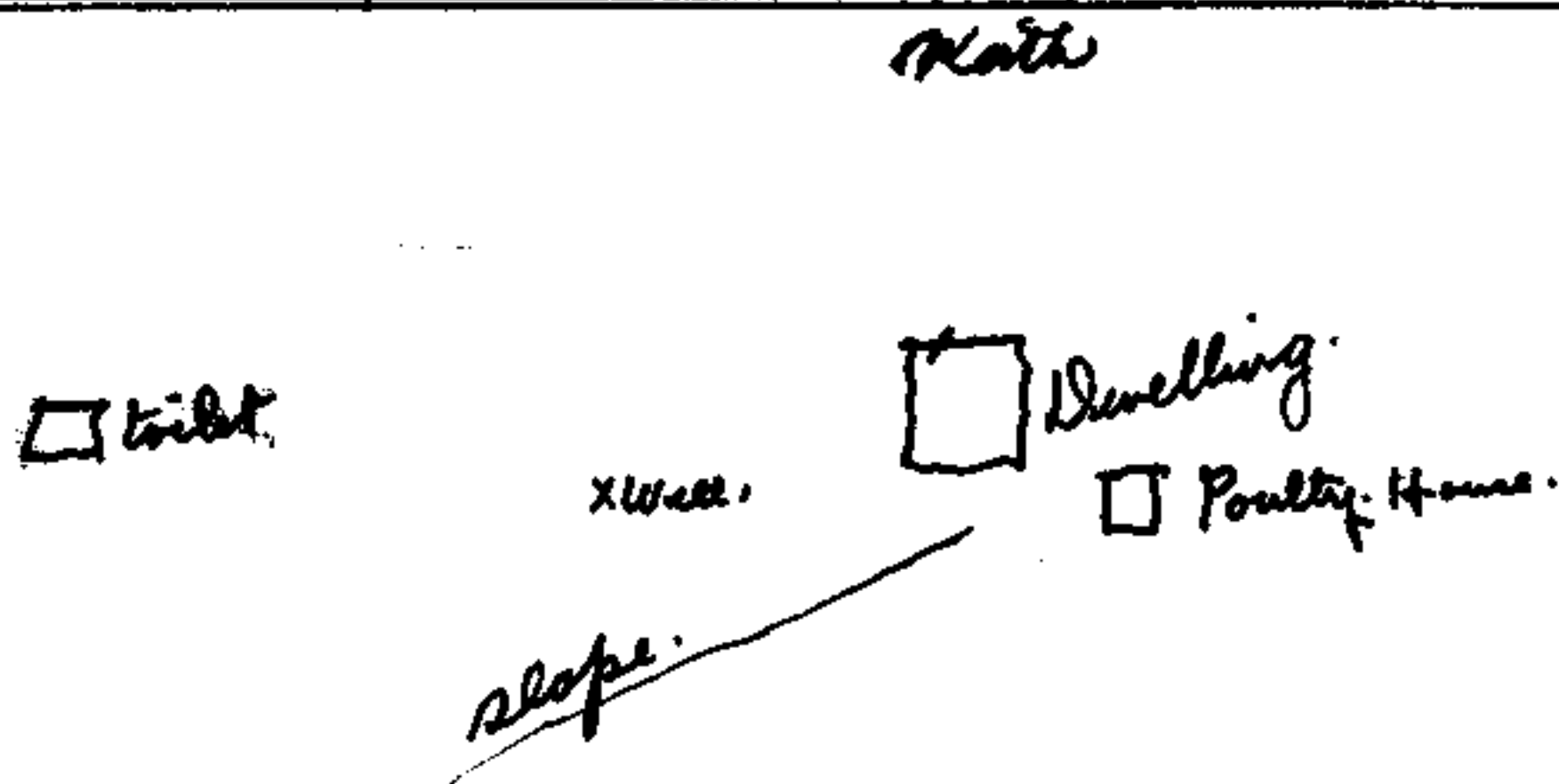

675