

WELL CONSTRUCTION REPORT
WISCONSIN STATE BOARD OF HEALTH
WELL CONSTRUCTION DIVISION

Duplicate

MAR 2 1943

Note: Section 31 of the Wisconsin Well Construction Code, having the force and effect of law, provides that within thirty days after completion of every well the driller shall submit a report covering all essential details of construction to the State Board of Health on a form provided by the Board.

Owner Lower Citron School Driller H. W. Bartels
 Street or RFD Jt. Dist # 8 Post Office Boscobel Wis
 Post Office Stuben, Wis. Date Oct 10, 1941 Permit No. 65

LOCATION OF PREMISES

Crawford County Haney, Eastman + Stuben Town

The square below represents a section of land divided into 40 acre tracts. Mark the position of the premises in the section.

Describe further by subdivision, plat, district, lake, lot.

block, nearest principal highway, etc., whichever apply.

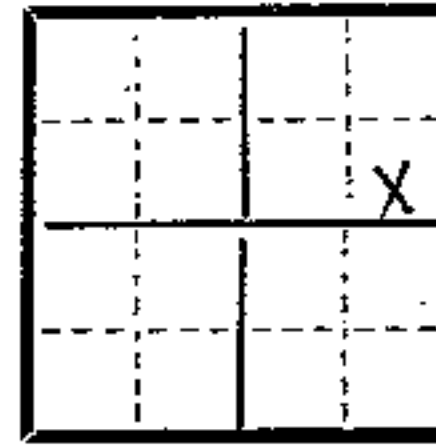

Sec. No. 33
 Twp. North 9
 Range 4 { ~~E~~ W

DIAGRAM OF PREMISES

See Well Construction Report bulletin. In making the diagram in the space below consider 10 ft. as the distance between lines. Be sure to indicate NORTH.

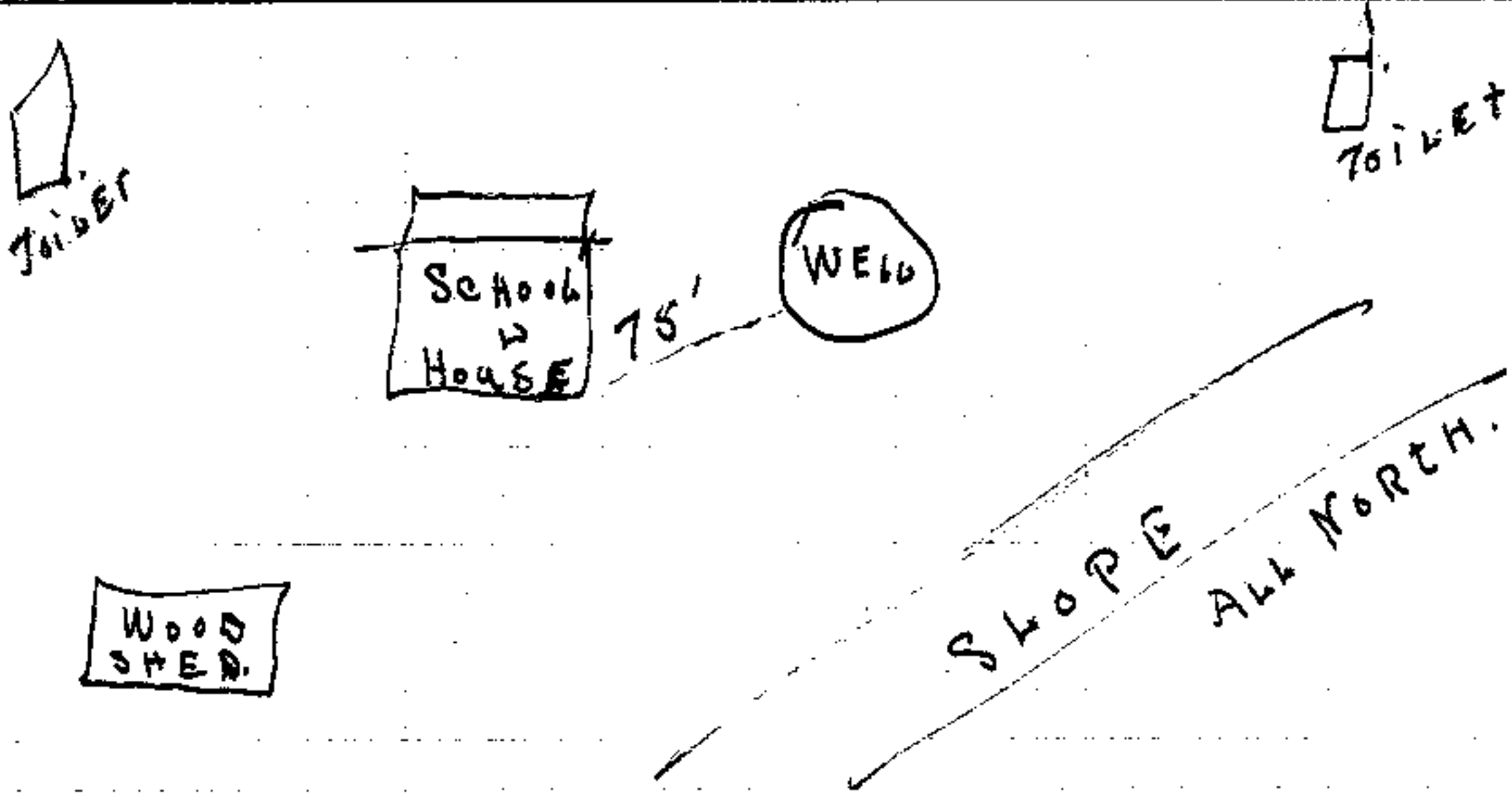

765