

Original

WELL CONSTRUCTION REPORT
WISCONSIN STATE BOARD OF HEALTH
WELL DRILLING DIVISION

CR-5

Note: Section 32 of the Wisconsin Well Drilling Sanitary Code, having the force and effect of law, provides that within thirty days after completion of every well the driller shall submit a report covering all essential details of construction to the State Board of Health on a form provided by the Board.

Owner United States Government Driller Kochenderfer + Sons
Street or RFD Commerce Building Post Office Fountain City, Wisconsin
Post Office St. Paul, Minn., Box 206 Date March 8, 1939 Permit No. 74

LOCATION OF PREMISES

Crawford County Lot 3 - Twp. 9 N Town

The square below represents a section of land divided into 40 acre tracts. Mark the position of the premises in the section.

Approx. 3.6 miles S.W. of Lynxville, Wis.
Describe further by subdivision, plat, district, lake, lot,
off highway #35 and adjacent to C.B. & Q
block, nearest principal highway, etc., whichever apply.
R.R. at Lock & Dam #9, Mississippi River

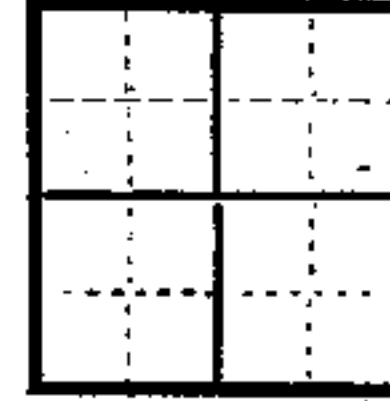

NW, NW, SE, NW, SW,
Sec. 33
Twp. 9 N
Range 6 W
4th P.M.

DIAGRAM OF PREMISES

See discussion and illustration in Part III Well Drilling Code. In making the diagram in the space below consider 10 ft. as the distance between lines. Be sure to indicate NORTH.

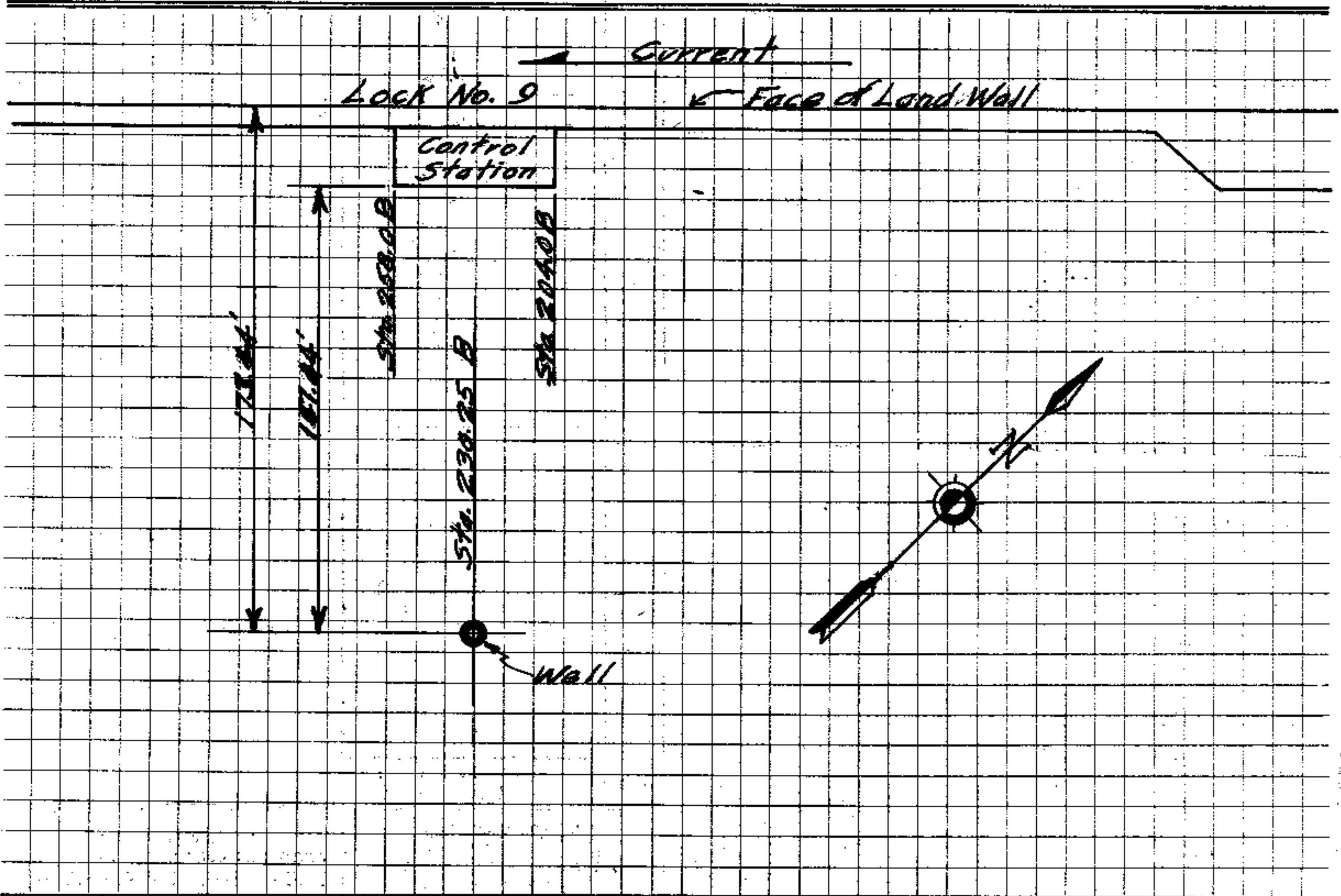

842