

Bot  
13

461214

JUN 14 1944

# WELL CONSTRUCTION REPORT

## WISCONSIN STATE BOARD OF HEALTH

### WELL CONSTRUCTION DIVISION

Note: Section 31 of the Wisconsin Well Construction Code, having the force and effect of law, provides that within thirty days after completion of every well the driller shall submit a report covering all essential details of construction to the State Board of Health on a form provided by the Board.

Owner R. H. Roberts Driller E. S. Waters  
Street or RFD 2215 Hollister ave. Post Office Boscobel - Wis.  
Post Office Madison, Wis. Date June 12 Permit No. 137

#### LOCATION OF PREMISES

Crawford County Clayton Town

The square below represents a section of land divided into 40 acre tracts. Mark the position of the premises in the section.



Sec. No. 26

Twp. North 10

Range 4 W E  
W

Describe further by subdivision, plat, district, lake, lot.

Highway K.  
block, nearest principal highway, etc., whichever apply.

#### DIAGRAM OF PREMISES

See Well Construction Report bulletin. In making the diagram in the space below consider 10 ft. as the distance between lines. Be sure to indicate NORTH.

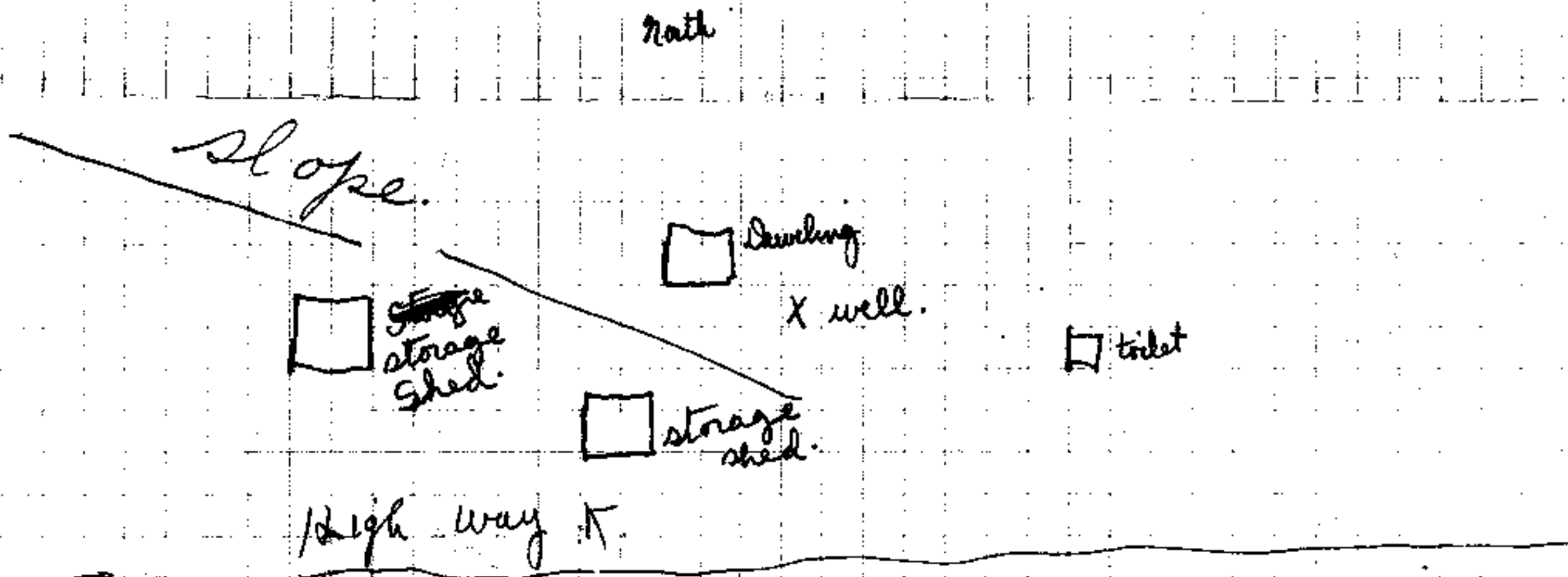

927